

Fig. 21 Assembling Engine Block
Cement E1, E2, and C24 to engine block. After you pass two leads of the motor through the hole of C27, cement C27 to engine block.

Fig. 22 Transmission Case Installation
Apply cement to fix D19 onto engine block. Then cement D41 to D19. Fix C6 and C9 onto engine block, making their pins located inside fit into the hole of gear box. And then cement C32 to C6 and C9.

Fig. 23 Half Shaft Installation (A)
Apply cement to fix D8 and D9 by aligning E27 sandwiched as illustrated. Be careful not to get cement down on E27. Cement D1 and D4, D28 and D29 respectively by aligning E27 sandwiched between them.

Fig. 24 Installing Engine Parts
Cement E25, E24, and C20 to ignition mounting board E21. Then cement this completed E21 to transmission case. Now pick water pump C15 where C18 and C16 are mounted already and cement this unit and the starter motor C19 to the engine. Apply decals of Lucas to the C20 and E24 Clear tube.

Fig. 25 Installing Engine Parts (cont'd)
Cement C16, C17, C14, and shifted D46 to the right side of engine.

Pump and Distributor
Cut clear tubes and black tubes to the length specified. Fit the clear tubes into C25 before you cement C26, E6, C30, and E26. Be sure to follow the illustration for putting the black tubes through E26.

21 Assembling Engine Block

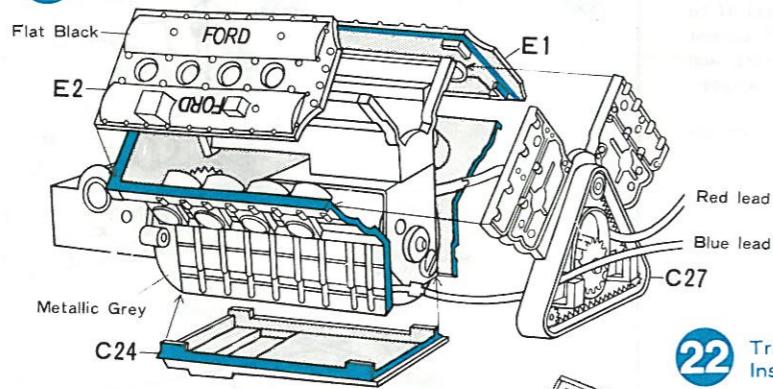

22 Transmission Case Installation

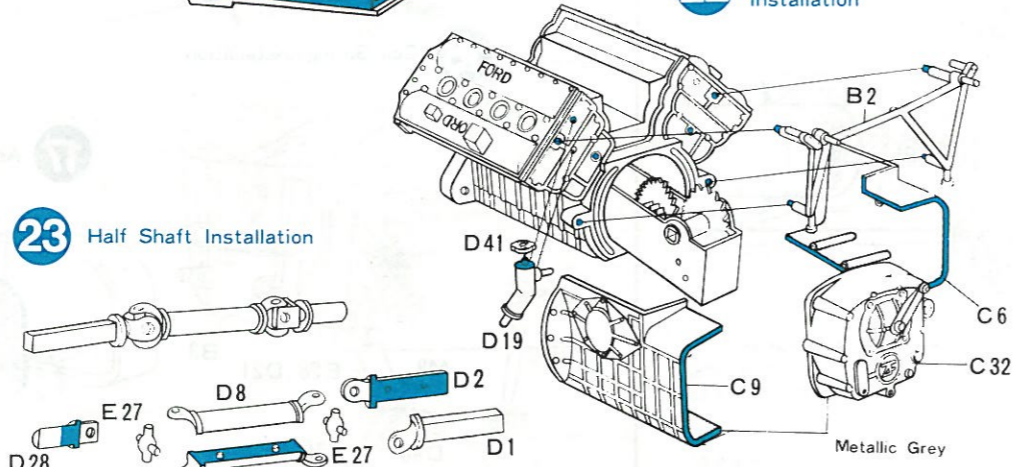

23 Half Shaft Installation

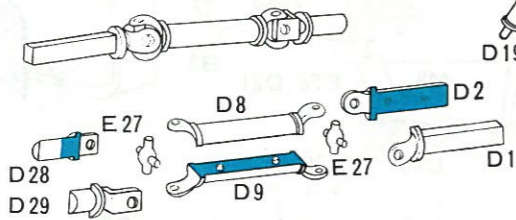

24 Installing Engine Parts

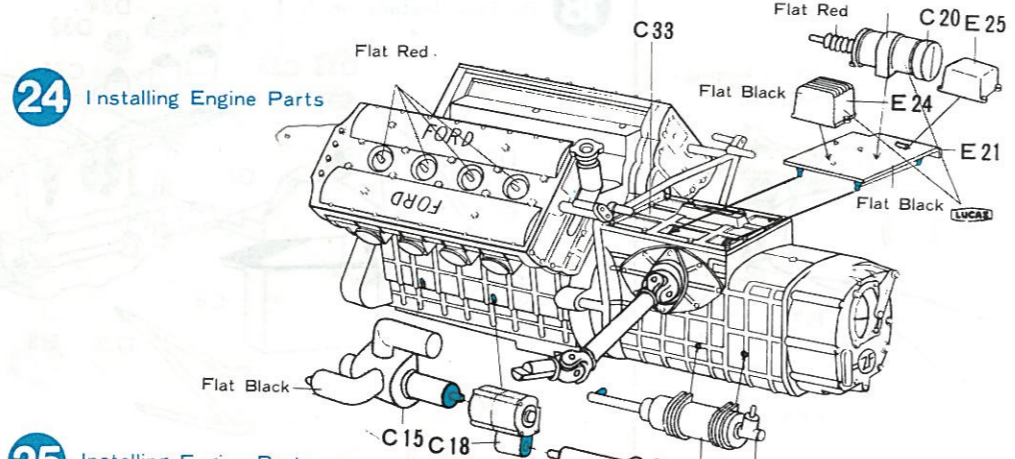

25 Installing Engine Parts (cont'd)

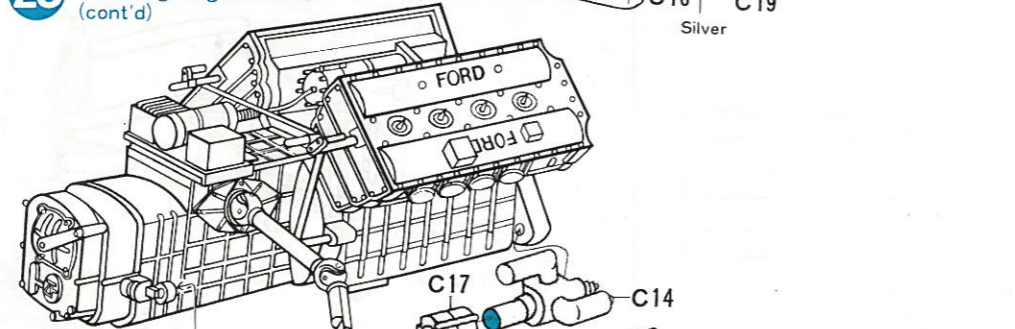

26 Assembly of Fuel Injection Pump and Distributor

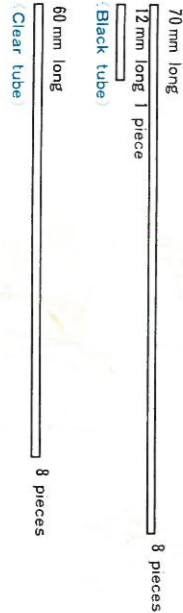
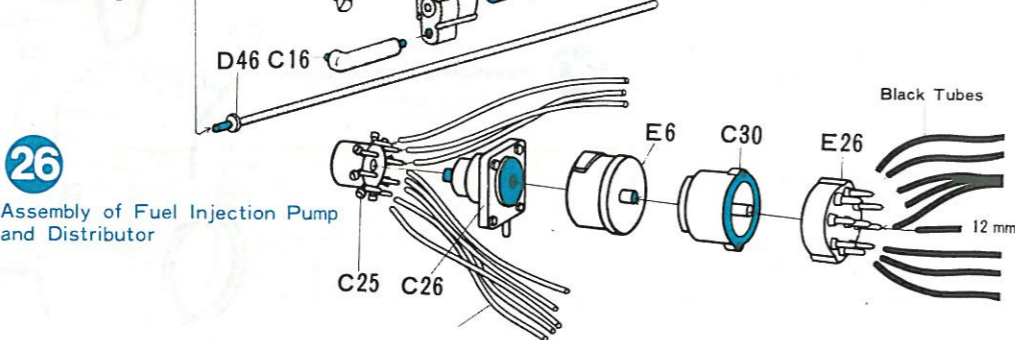

Fig. 27 Reservoir Tank Installation
Cement the pre-assembled fuel injection pump unit and distributor to the engine. Cut rubber tube to length of the illustration and fix it through D19.

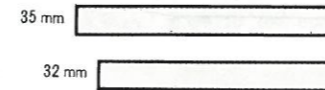

Fig. 28 Throttle Plate Installation
Cement the throttle plates C21 and C22 to the engine with the clear tubes sandwiched as illustrated. Cement D43 and D44 to C21 and C22 as shown. Then cement the air intake D13.

Fig. 29 Wiring
Study the diagram carefully and fix clear and black tubes in position.

Fig. 30 Exhaust Pipe Installation
Cement the exhaust pipes F1, F2, F3, and F4 to the right side of engine.

Fig. 31 Exhaust Pipe Installation (cont'd)
Cement the exhaust pipes F5, F6, F3, and F4 to the left side of engine.

Fix the right and left exhaust pipes through the exhaust pipe arm D12 and cement them together.

Fig. 33 Mounting Engine on the Body
Sort out leads coming out from the body and the engine. Joint the leads of same color together. Wrap the joints with adhesive tape to prevent short circuit. Then mount the engine on the body and, by fitting 10 mm long rubber tubes at the tips of C15 and C14, make sure that the rubber tubes and the tip of D46 pass through the holes in the body and cement the engine to the body.

Tape this connection to avoid any short circuit.



Cut two pieces of rubber tube to the illustrated measure.



★After placing two UM-3 Dry Batteries inside body, check the switch.

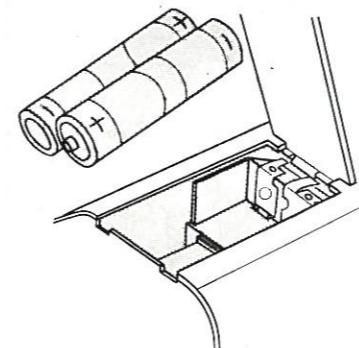

27 Reservoir Tank Installation

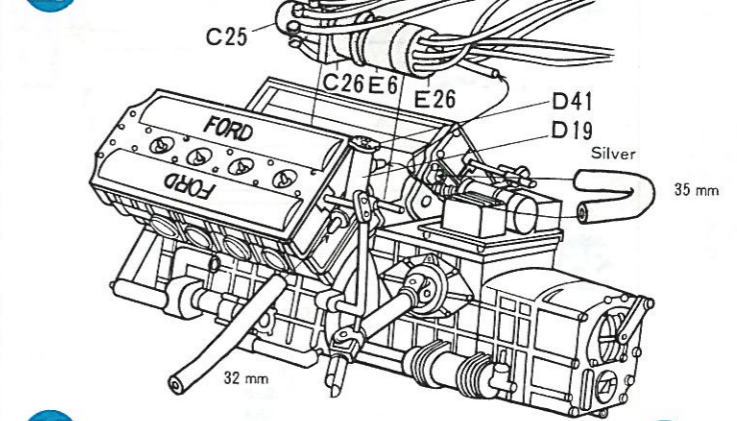

28 Throttle Plate Installation

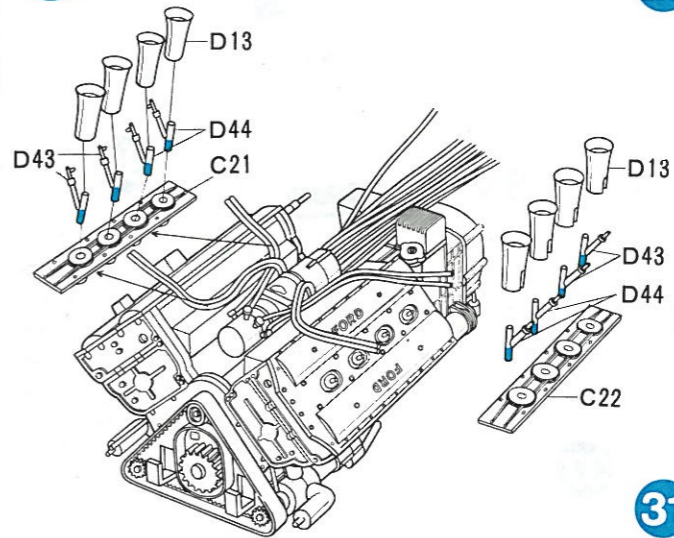

29 Wiring

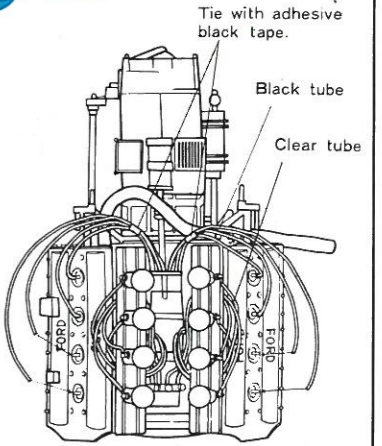

30 Exhaust Pipe Installation

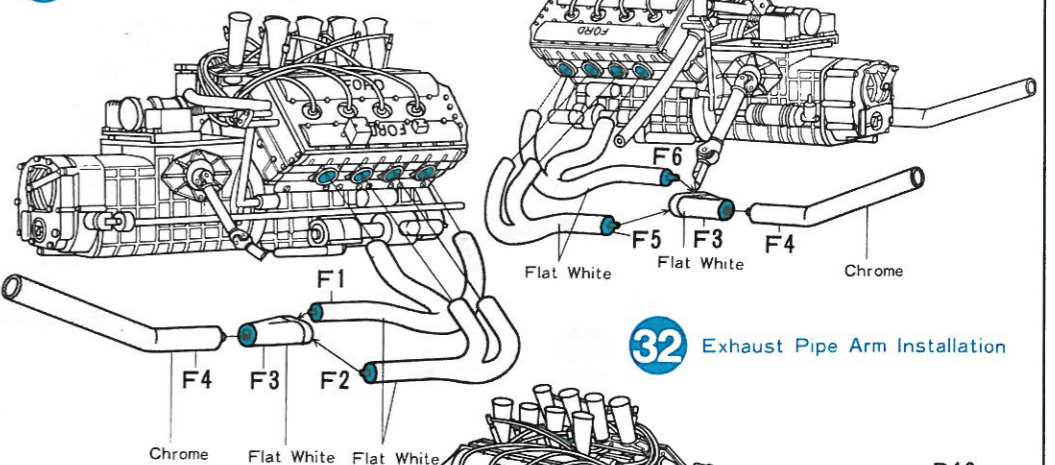

31 Exhaust Pipe Installation (cont'd)

32 Exhaust Pipe Arm Installation

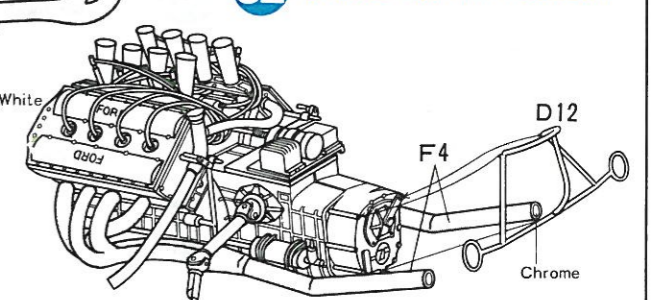

33 Mounting Engine on the Body

